

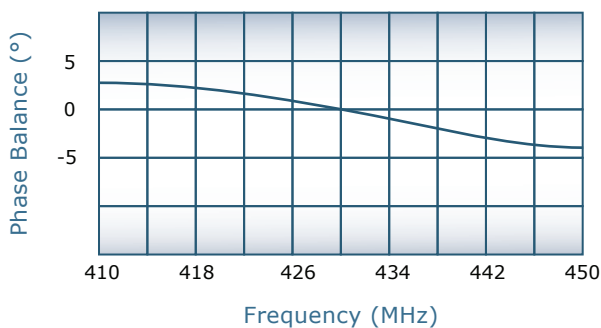

DECADES AHEAD[®]
high power RF devices

Werlatone[®], Inc.

17 Jon Barrett Road Patterson, New York 12563
T (845) 278 2220 www.werlatone.com
F (845) 278 3440 sales@werlatone.com

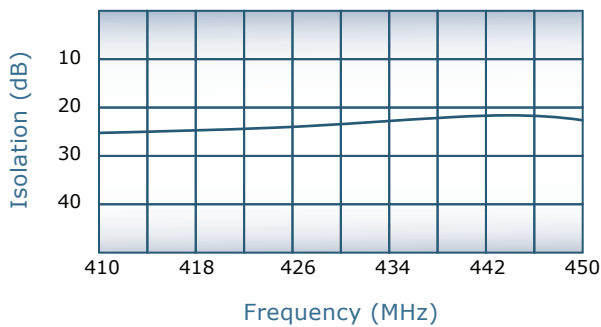
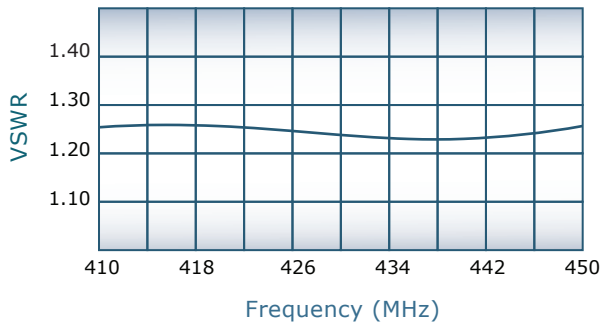
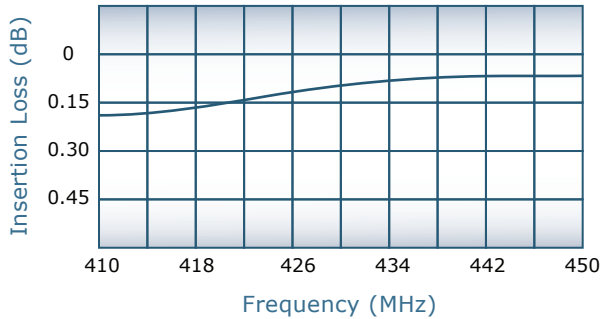

Specifications subject to change without notice

2-Way Combiner/Divider

Model D10659

Frequency: 410 - 450 MHz

Power: 1250 W CW
4 kW Peak @ 33% Duty Cycle

Insertion Loss: 0.3 dB Max.

VSWR: 1.35:1 Max.

Isolation: 20 dB Min.

Phase Balance: $\pm 4^\circ$ Max.

Amplitude Balance: ± 0.2 dB Max.

Notes

- Unit must be mounted to a heatsink with 4 mounting screws. Thermal conductive grease should be used. Unbalance power not to exceed 200 Watts @ +60°C baseplate temperature.
- All specifications guaranteed
- Test data provided with each unit shipped
- Alternate connector configurations upon request
- Operating Temperature: -55°C to +75°C

Connector Configurations

Model	J1 (Sum Port)	J2,J3 (Input/Output)
D10659-10	N Female	N Female
D10659-20	7/16 Fmale	N Female

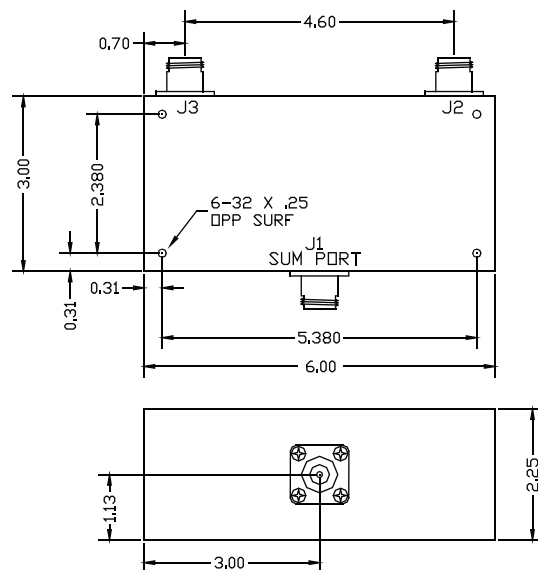

Send Us Your Specs for Custom Designs