**PRODUCT DATA SHEET**
**C5069**

**4-Port Dual Directional Coupler** employs two, 3-Port Uni-Directional Couplers, internally connected, in tandem, providing measurement of both forward and reverse power. Ideal for simultaneously monitoring a system's forward and reverse power and for reflectometer measurements. Unlike the Bi-Directional Coupler, the directivity of the Dual Directional Coupler is unaffected by the loads on the coupled ports.

**Features:**

High Power      Wide Bandwidths      Small Size      Flat Coupling      Custom Designs Available

**Electrical Specifications:**

Frequency:            1000 - 2000 MHz  
 Power:                1500 W CW  
 Coupling:            50 ± 1.0 dB Max.  
 Insertion Loss:      0.2 dB Max.  
 Flatness:            ± 0.3 dB Max.  
 VSWR (ML):        1.20:1 Max.  
 Directivity:         20 dB Min.

**Mechanical Specifications:**

Type:                    Connectorized  
 Material:              Aluminum 6061-T6  
 Surface Finish:      Chem. Film Per MIL-DTL-5541F  
                             Type I Class 3 (Yellow Iridite)  
                             RoHS Compliant Available  
 Operating Temperature: -55°C to +75°C  
 Storage Temperature: -60°C to +85°C  
 Humidity:             95% Non-Condensing  
 Size:                    3.0 x 3.0 x 1.09"

**Connector Configurations:**

Model	Input (J1)	Output (J2)	Fwd (J3)	Rev (J4)
C5069-10	N Female	N Female	N Female	N Female
C5069-12	N Female	N Female	SMA	SMA
C5069-13	N Female	N Female	BNC	BNC
C5069-20*	7/16 Female	7/16 Female	N Female	N Female
C5069-22*	7/16 Female	7/16 Female	SMA	SMA
C5069-23*	7/16 Female	7/16 Female	BNC	BNC
C5069-41	SC Female	SC Female	N Female	N Female
C5069-102	SMA	SMA	SMA	SMA
C5069-712	N Male	N Female	SMA	SMA
C5069-714	N Male	N Female	N Female	N Female
C5069-728*	7/16 Male	7/16 Female	SMA	SMA

\*Starred options are 3.0 x 3.0 x 1.59"

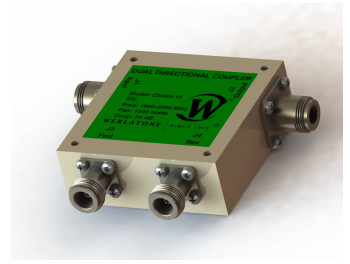

## Performance Data (Specifications subject to change without notice):

Coupling:

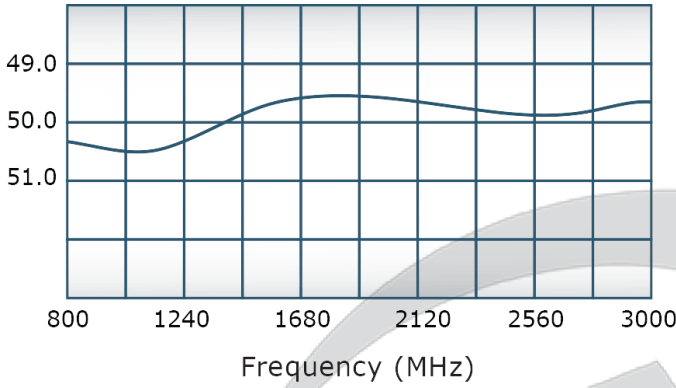

VSWR:

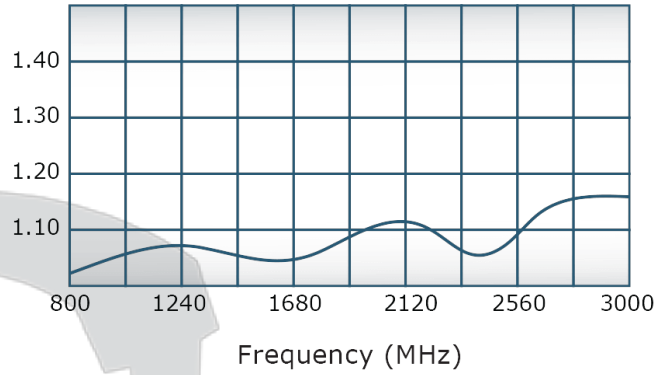

Insertion Loss:

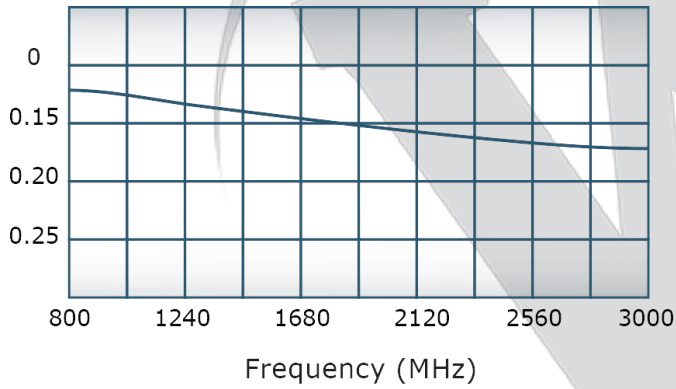

Directivity:

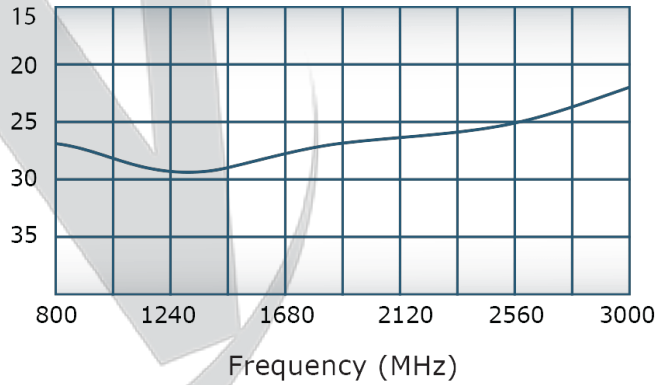

Restriction on use, duplication, or disclosure of proprietary information. This document contains proprietary information which is the sole property of

Werlatone, Inc.

Werlatone, Inc. 17 Jon Barrett Road Patterson, NY 12563 T:(845)278-2220 F:(845)278-3440 sales@werlatone.com www.werlatone.com

**RESTRICTION ON USE, DUPLICATION OR DISCLOSURE OF PROPRIETARY INFORMATION**  
 This document contains proprietary information which is the sole property of Werlatone, Inc.

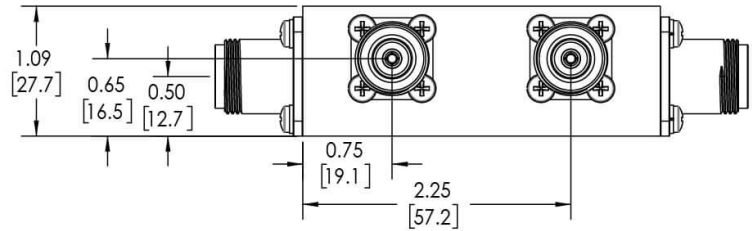
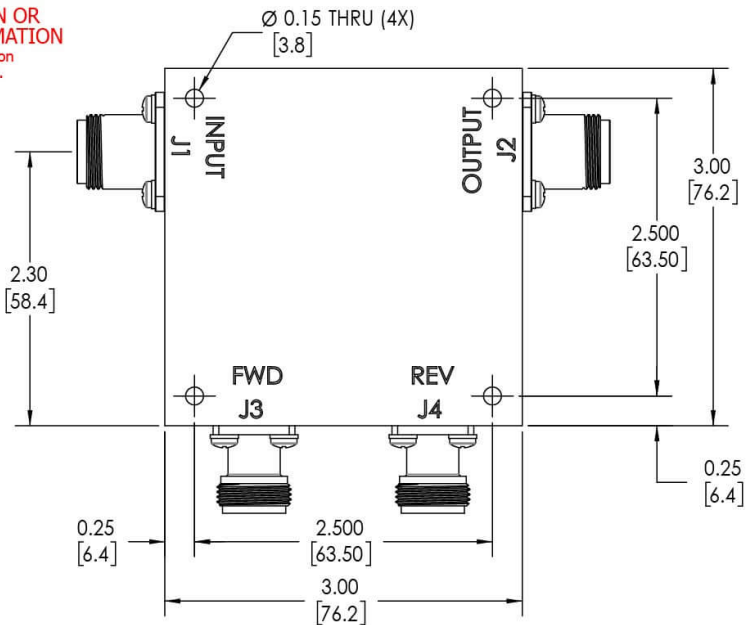

REVISION HISTORY			
REV.	REVISION RECORD	DATE	APPROVED
A	ECN 9696	11/27/18	RB

- NOTES: UNLESS OTHERWISE SPECIFIED**
- MATERIAL: ALUMINUM 6061-T6**
  - FINISH: CHEM FILM PER MIL-DTL-5541F TYPE I CLASS 3 (YELLOW IRIDITE)**
  - CONNECTORS: J1-J4: N FEMALE**

UNLESS OTHERWISE SPECIFIED		DWN	DATE	17 Jon Barrett Rd Patterson, NY 12563
INTERPRET DRAWING IAW MIL-STD-100		SD	2/11/2019	W WERLATONE SINCE 1965
DIMENSIONS PER ASME Y14.5M-2009		CHK	DATE	
PARENTHERTICAL INFO FOR REF ONLY		CS	2/11/2019	TITLE
DIMENSIONS ARE IN INCHES		ENGR	DATE	OUTLINE
DIMENSIONAL LIMITS APPLY BEFORE PROCESSES		MD	7/5/2001	SIZE
TOLERANCES:		INFR	DATE	CAGE CODE
ANGLES ± 2°		QA	DATE	DWG NO
3 PL ± .005 [13]		RLSE	DATE	10379-505
2 PL ± .015 [38]				REV
REMOVE ALL BURRS AND SHARP EDGES R.01 MAX				A
CONCENTRICITY MACHINED DIA: .002 FIM				SCALE
MACHINE TOOL MISMATCH .003 MAX.				1:1
NEXT ASSY	USED ON	THIRD ANGLE PROJECTION		SHEET 1 OF 1
APPLICATION				

Restriction on use, duplication, or disclosure of proprietary information. This document contains proprietary information which is the sole property of Werlatone, Inc.  
 Werlatone, Inc. 17 Jon Barrett Road Patterson, NY 12563 T:(845)278-2220 F:(845)278-3440 sales@werlatone.com www.werlatone.com