PRODUCT DATA SHEET
C2892

4-Port Dual Directional Coupler employs two, 3-Port Uni-Directional Couplers, internally connected, in tandem, providing measurement of both forward and reverse power. Ideal for simultaneously monitoring a system's forward and reverse power and for reflectometer measurements. Unlike the Bi-Directional Coupler, the directivity of the Dual Directional Coupler is unaffected by the loads on the coupled ports.

Features:

High Power Wide Bandwidths Small Size Flat Coupling Custom Designs Available

Electrical Specifications:

Frequency: 2 - 30 MHz
 Power: 25,000 W CW
 Coupling: 70 ± 1.0 dB Max.
 Insertion Loss: 0.05 dB Max.
 Flatness: ± 0.25 dB Max.
 VSWR (ML): 1.10:1 Max.
 Directivity: 30 dB Min.

Mechanical Specifications:

Type: Connectorized
 Material: Aluminum 6061-T6
 Surface Finish: Chem. Film Per MIL-DTL-5541F
 Type I Class 3 (Yellow Iridite)
 RoHS Compliant Available
 Operating Temperature: -55°C to +75°C
 Storage Temperature: -60°C to +85°C
 Humidity: 95% Non-Condensing
 Size: 6" Line Section

Connector Configurations:

Model	Input (J1)	Output (J2)	Fwd (J3)	Rev (J4)
C2892-81	1 5/8" EIA	1 5/8" EIA	N Female	N Female
C2892-82	1 5/8" EIA	1 5/8" EIA	N Male	N Male
C2892-83	1 5/8" EIA	1 5/8" EIA	SMA	SMA
C2892-84	1 5/8" EIA	1 5/8" EIA	BNC	BNC

Werlatone® Broadband Dual, Uni, and Bi Directional RF Couplers are designed to tolerate the most stringent operating conditions associated with military and EMC testing environments. Many of our RF Directional Couplers, designated Mismatch Tolerant®, will operate continuously, at rated power, into a severe load mismatch condition. Our multi-octave Directional Couplers maintain exceptional coupling flatness, directivity, VSWR, and insertion loss.

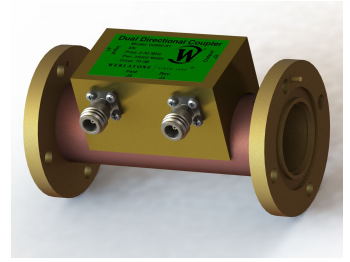

PRODUCT DATA SHEET

C2892

Performance Data (Specifications subject to change without notice):

Coupling:

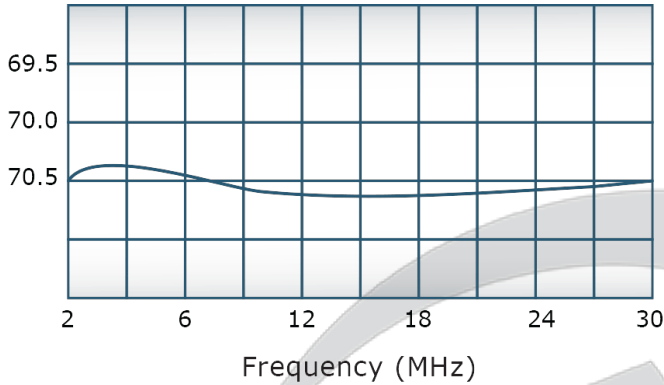

VSWR:

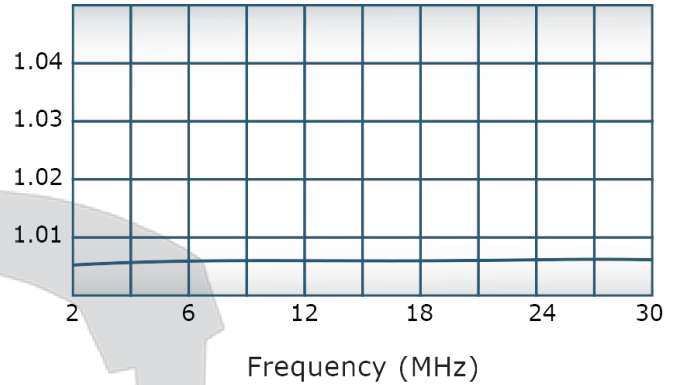

Insertion Loss:

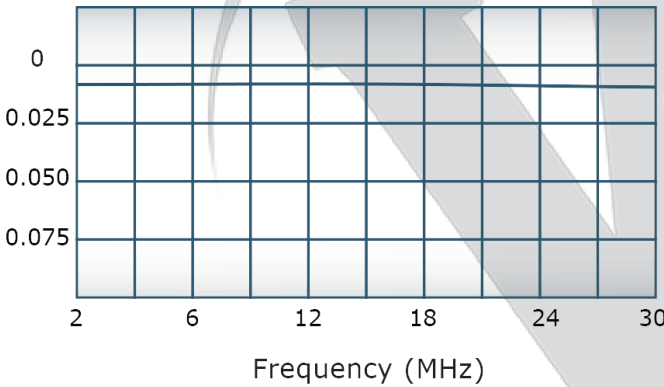

Directivity:

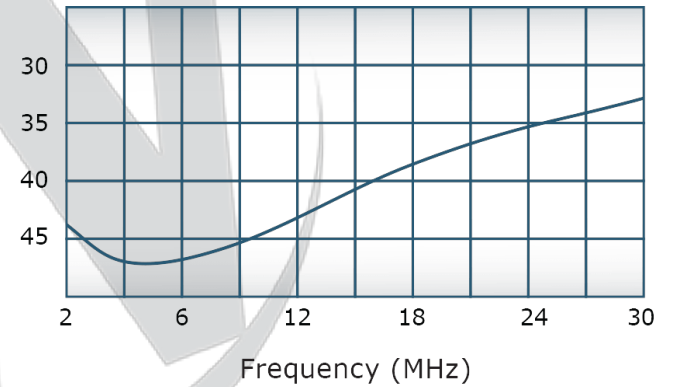

Restriction on use, duplication, or disclosure of proprietary information. This document contains proprietary information which is the sole property of

Werlatone, Inc.

Werlatone, Inc. 17 Jon Barrett Road Patterson, NY 12563 T:(845)278-2220 F:(845)278-3440 sales@werlatone.com www.werlatone.com

RESTRICTION ON USE, DUPLICATION OR DISCLOSURE OF PROPRIETARY INFORMATION
 This document contains proprietary information which is the sole property of Werlatone, Inc.

REVISION HISTORY			
REV.	REVISION RECORD	DATE	APPROVED
A	ECN 9696	11/29/18	RB

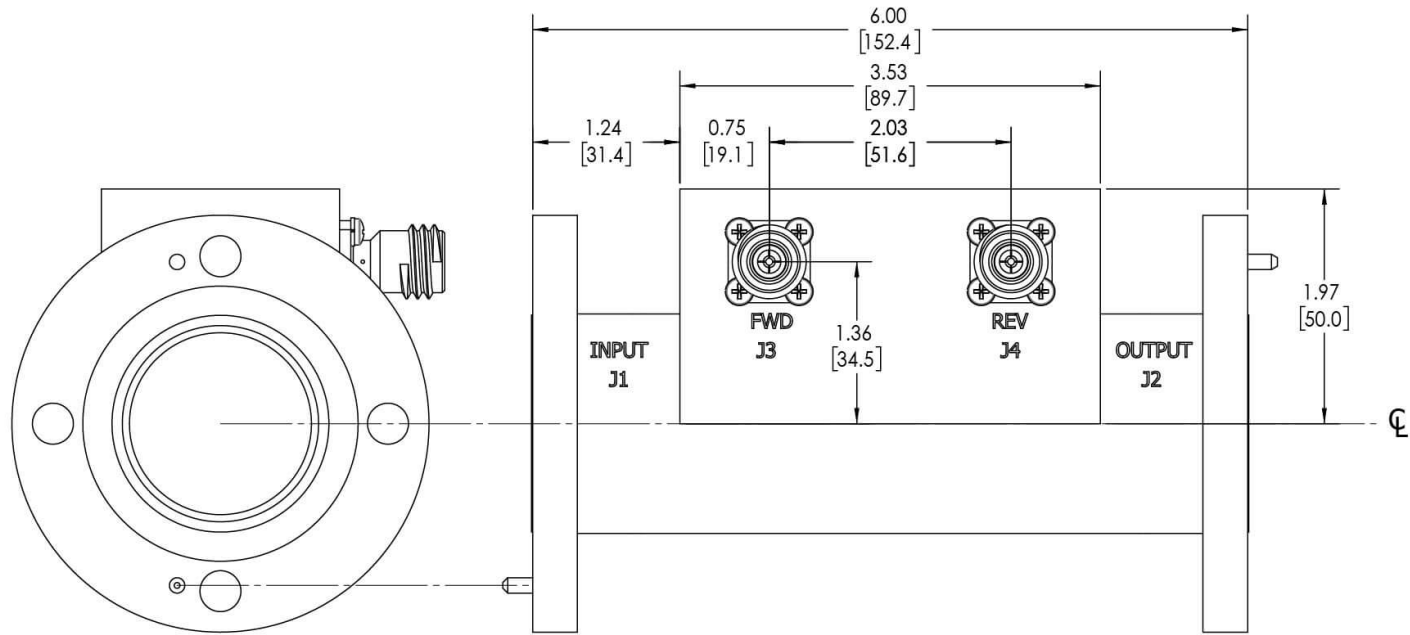

NOTES:
 1. **CONNECTORS:**
 J1, J2: 1 5/8 EIA STANDARD
 J3, J4: N FEMALE

UNLESS OTHERWISE SPECIFIED		APP	DATE	17 Jon Barrett Rd Patterson, NY 12563
INTERPRET DRAWING IAW MIL-STD-100	SD	2/11/2019		
DIMENSIONS FOR ASME Y14.5M-2009	CHK	DATE		17 Jon Barrett Rd Patterson, NY 12563
PARENTHESES FOR REF ONLY	CS	2/11/2019		
DIMENSIONS ARE IN INCHES	ENGR	DATE		17 Jon Barrett Rd Patterson, NY 12563
DIMENSIONAL LINES APPLY BEFORE PROCESSES	DK	8/4/1992		
TOLERANCES:	INFR	DATE		17 Jon Barrett Rd Patterson, NY 12563
ANGLES ± 2°	QA	DATE		
3 PL ± .005 [13]	RLSE	DATE		17 Jon Barrett Rd Patterson, NY 12563
2 PL ± .015 [38]				
REMOVE ALL BURRS AND SHARP EDGES R.01 MAX				17 Jon Barrett Rd Patterson, NY 12563
CONCENTRICITY MACHINED DIA: .002 FIM				
MACHINE TOOL MISMATCH .003 MAX				
NEXT ASSY	USED ON	APPLICATION	THIRD ANGLE PROJECTION	

TITLE		REV
OUTLINE		A
SIZE	CAGE CODE	DWG NO
B	10093-501	
SCALE	SHEET 1 OF 1	
1:1		

Restriction on use, duplication, or disclosure of proprietary information. This document contains proprietary information which is the sole property of Werlatone, Inc.
 Werlatone, Inc. 17 Jon Barrett Road Patterson, NY 12563 T:(845)278-2220 F:(845)278-3440 sales@werlatone.com www.werlatone.com