

PRODUCT DATA SHEET

WPM11340

Instantaneous & Simultaneous

- Local and/or Remote Monitoring
- Forward Power Reading/Monitoring (Watts or dBm)
- Reverse Power Reading/Monitoring (Watts or dBm)
- VSWR Readings (Watts, Return Loss, Rho)

VSWR Alarm

- Customer can set up audio/visual alarm via relay contacts.
- Signal sent to closed loop.

Temperature Monitoring (with alarm)

- One sensor, internal measurement, within Power Meter.
- One sensor, external measurement, to be placed by customer.

General Purpose Inputs (6 ea) Multiple Use

- Track switch closures (assign to interlock group).
- Trigger alarm relay (sends email alert).
- RF presence status/alarm (safety feature).
- Alarm, activated switch.

Accessories:

- Single Channel and Multi-Channel Displays
- RF Digital Dashboard Spreadsheet Software, (Simultaneously Monitor Outputs of 30+ Power Meters)
- PC Based Graphical User Interface Windows XP/7/8/10 Compatible

Accuracy:

- $\pm 2\%$ to Customer Calibration Standard, at preselected frequencies.
- $\pm 5\%$ over a Multi-Octave Bandwidth
- Werlatone Calibration Traceable to (NIST) National Institute of Standards and Technology

Power:

- AC Power Adapter (100/240 50-60 Hertz V AC)
- POE (Passive Over Ethernet, Optional POE Injector Kit Available)
- Via RS485 (Via Single Channel or Multi-Channel Displays)

Interface (Via):

- TCP/IP - SNMP and Browser Interface via Local Area Network
- RS232, Serial
- RS485 - Form Addressable Serial Network
- User ID and Password Protected for Access and Control
- Multiple units can be Networked and Simultaneously Monitored On-Site or Remotely (TCP/IP/SNMP/Serial)

RoHS Compliant Design Available
Custom Connector Configurations Available

Electrical Specifications:

Frequency: 20 - 1000 MHz
Power: 1000 W CW

Mechanical Specifications:

Type: Connectorized
Operating Temperature: -55°C to $+75^{\circ}\text{C}$
Storage Temperature: -60°C to $+85^{\circ}\text{C}$

Connector Configurations:

Model	Input(J1)	Output(J2)
WPM11340-12	N Female	N Female
WPM11340-22	7/16 Female	7/16 Female
WPM11340-622	7/16 Female	7/16 Male
WPM11340-728	7/16 Male	7/16 Female

RESTRICTION ON USE, DUPLICATION OR DISCLOSURE OF PROPRIETARY INFORMATION
 This document contains proprietary information which is the sole property of Werlatone, Inc.

REVISION HISTORY			
REV.	REVISION RECORD	DATE	APPROVED
-	INITIAL RELEASE	10/15/2018	CS

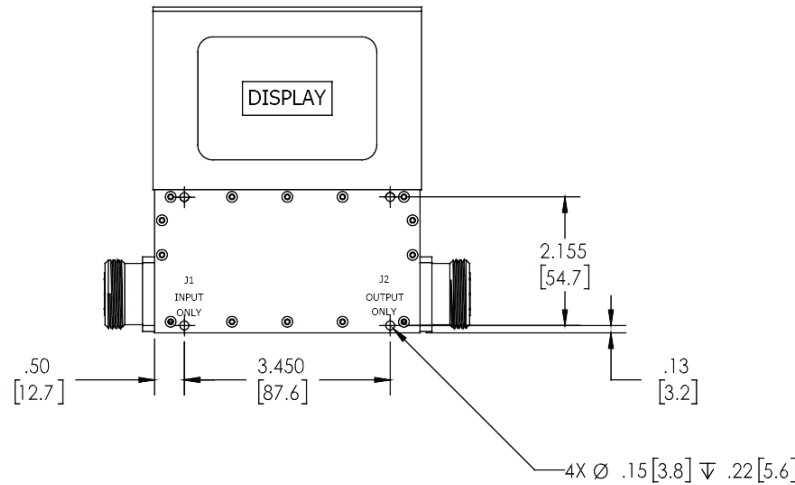
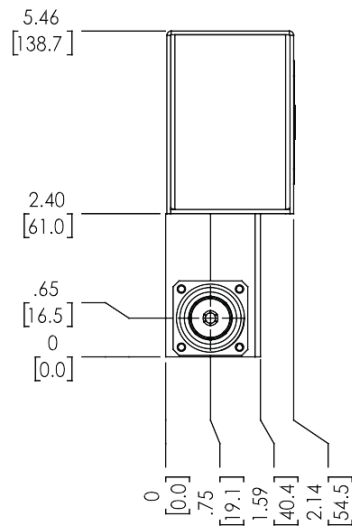
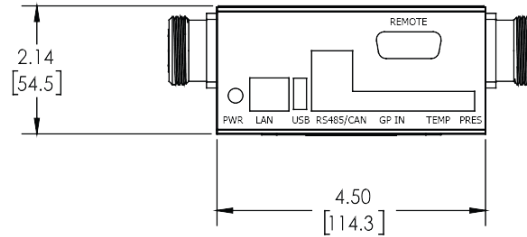

		UNLESS OTHERWISE SPECIFIED		OWN	DATE	17 Jon Barrett Rd Patterson, NY 12563	
		• INTERPRET DRAWING 100% MTD-100		PLP	9/27/2018	WERLATONE SINCE 1965	
		• CONSIDERING FOR ASME Y14.5M-2009		CHK	DATE		
		• PARENTETICAL INFO FOR REV ONLY		CS	10/15/2018	TITLE	
		• DIMENSIONS ARE IN INCHES (mm)		ENGR	DATE	SIZE CAGE CODE DWG NO	
		• DIMENSIONAL LIMITS APPLY BEFORE PROCESSES		DATE	DATE	REV	
		• TOLERANCES:		DATE	DATE	B 28812 21656-500	
		ANGLES: 8°		DATE	DATE	SCALE 1:2	
		2 PL ± .005 (.13)		DATE	DATE	SHEET 1 OF 1	
		2 PL ± .015 (.4)		DATE	DATE		
		• REMOVE ALL BURRS AND SHARP EDGES R.01 MAX		DATE	DATE		
		• CONCENTRICITY MACHINED DIA: .002 FIM		DATE	DATE		
		• MACHINE TOOL MESH/NOTCH .003 MAX		DATE	DATE		
NEXT ASSY		THIRD ANGLE PROJECTION		DATE	DATE		
WPM11340		APPLICATION					
USED ON							

Restriction on use, duplication, or disclosure of proprietary information. This document contains proprietary information which is the sole property of Werlatone, Inc.
 Werlatone, Inc. 17 Jon Barrett Road Patterson, NY 12563 T:(845)278-2220 F:(845)278-3440 sales@werlatone.com www.werlatone.com