PRODUCT DATA SHEET
D9493

Werlatone® Mismatch Tolerant® High Power Broadband RF Combiners and Dividers will operate into High Load VSWR Conditions, for extended periods, without damage. With extensive experience as a supplier to military platforms worldwide **Werlatone®** designs its High Power Broadband Combiners, Power Dividers, and N-Way Combiners for proper operation in the most stringent operating conditions.

Features:

High Power Wide Bandwidths Small Size Custom Designs Available

Electrical Specifications:

Frequency:	400 - 500 MHz
Power:	100 W CW
Insertion Loss:	0.4 dB Max.
VSWR:	1.30:1 Max.
Phase Balance:	± 3° Max.
Amplitude Balance:	0.25 dB Max.
Isolation:	No Isolation

Mechanical Specifications:

Type:	Connectorized
Material:	Aluminum 6061-T6
Surface Finish:	Chem. Film Per MIL-DTL-5541F Type I Class 3 (Yellow Iridite) RoHS Compliant Available
Operating Temperature:	-55°C to +75°C
Storage Temperature:	-60°C to +85°C
Weight:	3 lbs.
Size:	9.5 x 4.1 x 1.125"

Connector Configurations:

Model	Sum Port (J9)	Input/Output (J1-J8)
D9493-10	N Female	N Female

When specified, Werlatone® High Power Combiners and RF Dividers will tolerate full input failures on adjacent port(s). This insures that remaining transmitter(s) may continue to operate until the amplifier system can be properly shut down for maintenance. Choose your specific connector configuration from a list of options. Additional connector configurations for our High Power RF Combiners/Dividers, Non-Coherent Combiners, and N-Way Combiners are available upon request.

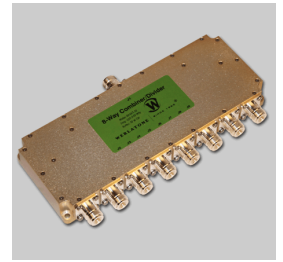

Performance Data (Specifications subject to change without notice):

Insertion Loss:

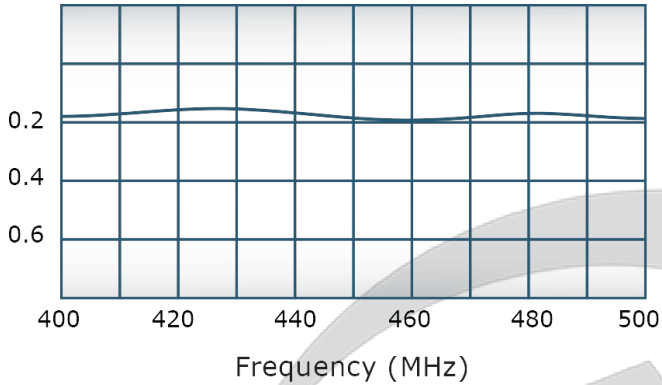

VSWR:

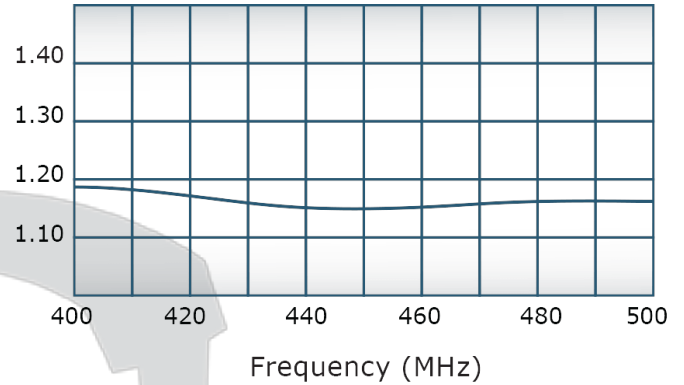

For In-Building Applications:



Phase Balance:

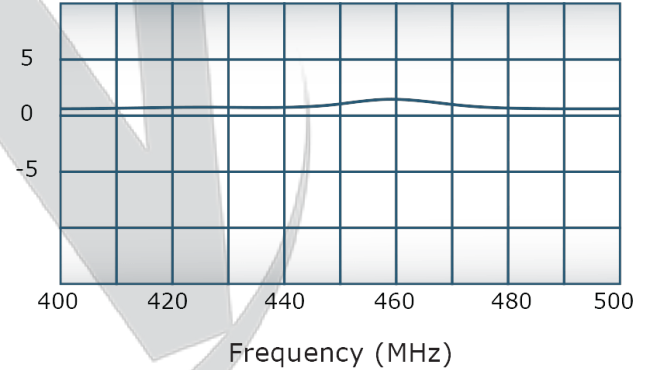

RESTRICTION ON USE, DUPLICATION OR DISCLOSURE OF PROPRIETARY INFORMATION
 This document contains proprietary information which is the sole property of Werlatone, Inc.

REVISIONS			
REV.	REVISION RECORD	DATE	APPROVED
-	PRE-RELEASE	10/16/12	BW

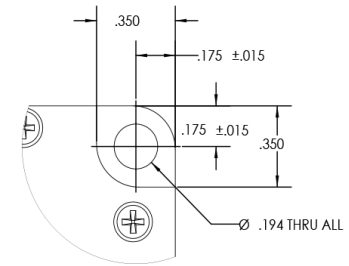
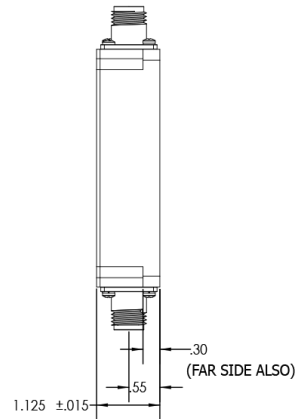
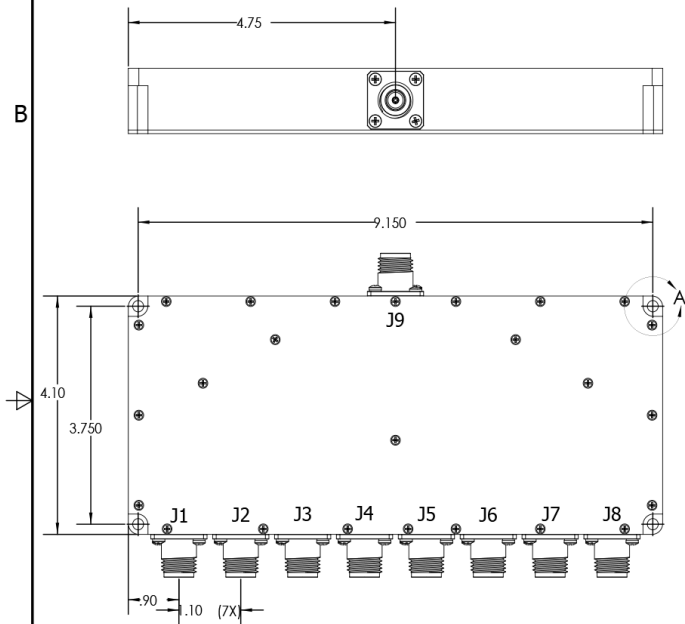

UNLESS OTHERWISE SPECIFIED		OWN	DATE	WERLATONE SINCE 1965 17 Jon Barrett Rd Patterson, NY 12563
INTERPRET DRAWING IN ACCORDANCE WITH MIL-STD-100 DIMENSIONS ARE PER ASME Y14.5M-2009 DIMENSIONS ARE IN INCHES DIMENSIONAL UNITS APPLY BEFORE PROCESSES TOLERANCES: ANGLES = 3° 3 PL = .005 2 PL = .015		CHK	DATE	
20952-300 REV-		ENGR	DATE	TITLE
NEXT ASSY		MPGR	DATE	SIZE
APPLICATION		QA	DATE	CAGE CODE
THIRD ANGLE PROJECTION		RELE	DATE	DWG NO
		SCALE		REV
		1:2		B 28812 20952-500
				SHEET 1 OF 1

Restriction on use, duplication, or disclosure of proprietary information. This document contains proprietary information which is the sole property of Werlatone, Inc.
 Werlatone, Inc. 17 Jon Barrett Road Patterson, NY 12563 T:(845)278-2220 F:(845)278-3440 sales@werlatone.com www.werlatone.com