



PRODUCT DATA SHEET

QH9056

Our patented 3 dB 90° Hybrid Couplers provide:

- Superior component performance starting at 3:1 Bandwidth.
- Thicker center boards for high power and increased repeatability.
- Bonded structures which eliminate any air gaps between substrates.
- More sections per bandwidth for better coupling flatness.
- Electrically shorter and physically smaller RF components.

Features:

High Power Wide Bandwidths Small Size Excellent Amplitude Balance

Electrical Specifications:

Frequency: 30 - 520 MHz
 Power: 400 W CW
 Insertion Loss: 0.8 dB Max.
 VSWR: 1.30:1 Max.
 Phase Balance: 90° ± 8° dB Max.
 Amplitude Balance: ± 1.2 dB Max. (35-520 MHz)
 ± 1.35 dB at 30 MHz
 Isolation: 18 dB Min.

Mechanical Specifications:

Type: Surface Mount
 Plating Options: QH9056-Pb: Electrodeposited Tin/Lead
 QH9056-Sn: Immersion Tin (RoHS Compliant)
 QH9056-Ag: Immersion Silver (RoHS Compliant)
 QH9056-Au (ENIG)
 Weight: 3.8 oz.
 Size: 4.0 x 1.7 x 0.29"

Port Configurations:

J1	J2	J3	J4
Input	-3 dB, 0°	-3 dB, -90°	Isolated
-3 dB, 0°	Input	Isolated	-3 dB, -90°
-3 dB, -90°	Isolated	Input	-3 dB, 0°
Isolated	-3 dB, -90°	-3 dB, 0°	Input

Werlatone's breakthrough technology allows us to build our existing line of Broadband 3 dB High Power 90° Hybrid Couplers. Connectorized 3 dB 90° Hybrid Coupler models are available with a choice of connectors. Several of our existing High Power 3 dB 90° RF Couplers are three port designs, wherein the difference port is internally terminated with a high power termination. This eliminates the need for a customer supplied external load for each Hybrid Coupler.



WERLATONE

Model QH9056



PRODUCT DATA SHEET

QH9056

Performance Data (Specifications subject to change without notice):

Coupling:

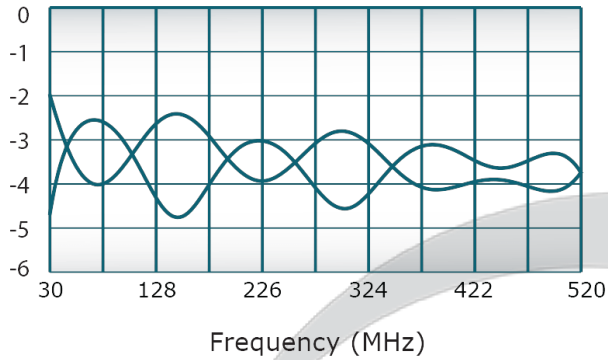

VSWR:

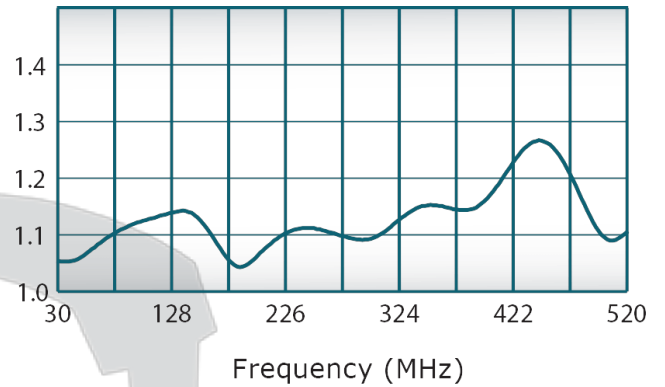

Isolation:

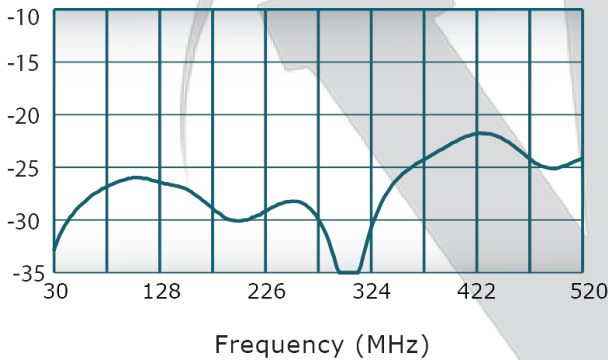

Phase Balance:

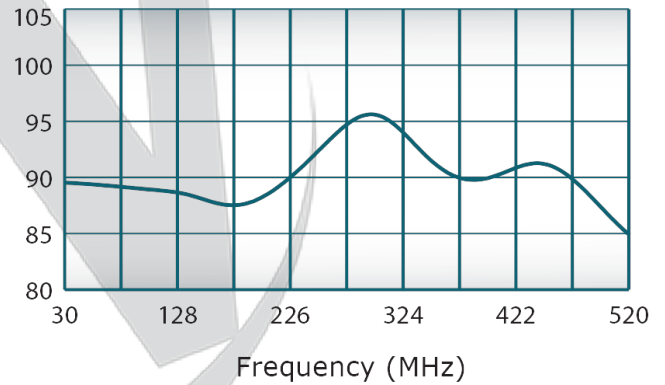

Restriction on use, duplication, or disclosure of proprietary information. This document contains proprietary information which is the sole property of Werlatone, Inc.

Werlatone, Inc. 17 Jon Barrett Road Patterson, NY 12563 T:(845)278-2220 F:(845)278-3440 sales@werlatone.com www.werlatone.com

RESTRICTION ON USE, DUPLICATION OR DISCLOSURE OF PROPRIETARY INFORMATION

This document contains proprietary information which is the sole property of Werlatone, Inc.

REVISION HISTORY

REV	REVISION RECORD	DATE	APPROVED
-	INITIAL RELEASE	5/24/2012	BW
A	ECN 8375	11/5/2013	BW
B	ECN 10549	1/26/2024	BW

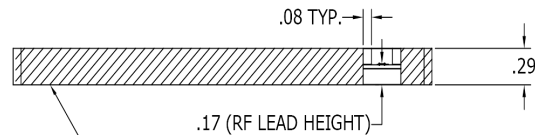
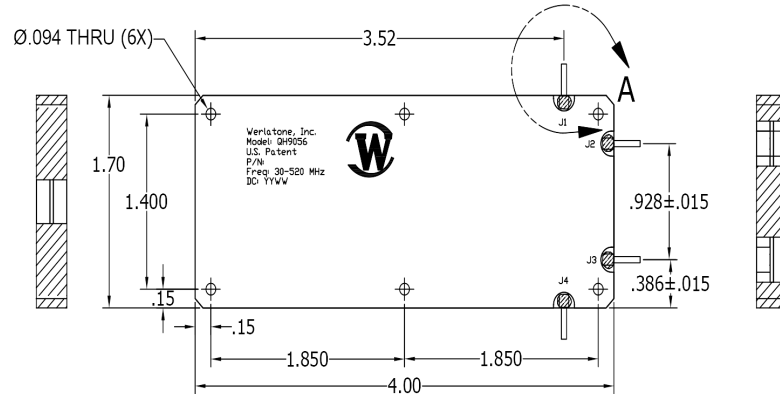

Edge Plate Entire Perimeter Except for .080 on Either Side of Pockets (4X)

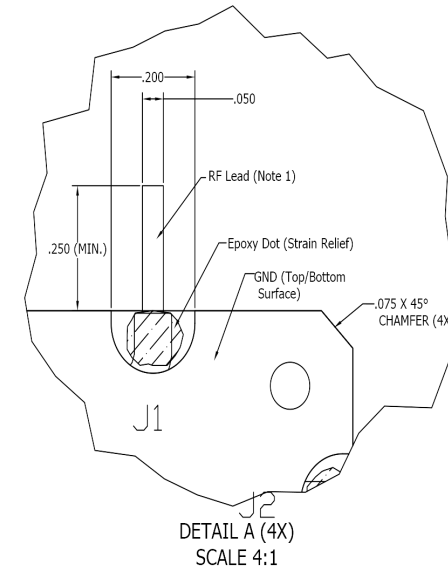

NOTES: UNLESS OTHERWISE SPECIFIED

1. RF LEAD MATERIAL: 99.95% PURE SILVER. .005 THICK. LEAD IS RESISTANCE WELDED TO EXPOSED COPPER STRIPLINE TRACE. THERMALLY CONDUCTIVE EPOXY DOT IS FOR STRAIN-RELIEF PURPOSES ONLY AND IS NOT AN ELECTRICALLY CONDUCTIVE MATERIAL.

2. SEE 90° DROP-IN APPLICATION NOTE FOR MORE INFORMATION

3. ORDERING INFORMATION:

QH9056-AG-

Surface Finish
Pb: ED Tin/Lead
Ag: Immersion Silver
Sn: Immersion Tin
Au: ENIG

INTERFACE
-T: RF TABS / LEADS
BLANK: NO TABS. SOLDER PAD.

ELECTRICAL SPECIFICATIONS

Frequency: 30 - 520 MHz
Power: 400 Watts CW
Insertion Loss: 0.8 db Max.
Amplitude Balance: ± 1.2 db Max. (35-520 MHz.)
 ± 1.35 db at 30 MHz
Phase Balance: $90^\circ \pm 8^\circ$ Max.
VSWR: 1.3:1 Max.
Isolation: 18 dB Min.
Operating Temperature: -55°C to +85°C

Port Configurations

J1	J2	J3	J4
Input	-3 dB, 0°	-3 dB, -90°	Isolated
-3 dB, 0°	Input	Isolated	-3 dB, -90°
-3 dB, -90°	Isolated	Input	-3 dB, 0°
Isolated	-3 dB, -90°	-3 dB, 0°	Input

UNLESS OTHERWISE SPECIFIED

- INTERPRET DRAWING IN ACCORDANCE WITH MIL-STD-883C
- DIMENSIONING PER ASME Y14.5M-2009
- PARENTHESES ARE FOR REF ONLY
- DIMENSIONS ARE IN INCHES
- DIMENSIONAL LIMITS APPLY BEFORE PROCESSES
- TOLERANCES: ANGLES $\pm 2^\circ$
3 PL $\pm .005$
2 PL $\pm .015$

THIRD ANGLE PROJECTION

DATE	DATE	DATE	DATE	DATE	DATE	DATE	DATE	DATE	DATE
5/24/2012	5/24/2012	5/24/2012	5/24/2012	5/24/2012	5/24/2012	5/24/2012	5/24/2012	5/24/2012	5/24/2012
GP	GP	GP	GP	GP	GP	GP	GP	GP	GP
DATE	DATE	DATE	DATE	DATE	DATE	DATE	DATE	DATE	DATE
DATE	DATE	DATE	DATE	DATE	DATE	DATE	DATE	DATE	DATE
DATE	DATE	DATE	DATE	DATE	DATE	DATE	DATE	DATE	DATE
DATE	DATE	DATE	DATE	DATE	DATE	DATE	DATE	DATE	DATE
DATE	DATE	DATE	DATE	DATE	DATE	DATE	DATE	DATE	DATE
DATE	DATE	DATE	DATE	DATE	DATE	DATE	DATE	DATE	DATE
DATE	DATE	DATE	DATE	DATE	DATE	DATE	DATE	DATE	DATE



WERLATONE | SINCE 1965

17 Jon Barrett Rd
Patterson, NY 12563

TITLE

QH9056 3dB 90° Hybrid Coupler

SIZE

B

28812

SCALE

1:1

SHEET 1 OF 1

Restriction on use, duplication, or disclosure of proprietary information. This document contains proprietary information which is the sole property of Werlatone, Inc.
Werlatone, Inc. 17 Jon Barrett Road Patterson, NY 12563 T:(845)278-2220 F:(845)278-3440 sales@werlatone.com www.werlatone.com