

## PRODUCT DATA SHEET

QH10738

### Our patented 3 dB 90° Hybrid Couplers provide:

- Superior component performance starting at 3:1 Bandwidth.
- Thicker center boards for high power and increased repeatability.
- Bonded structures which eliminate any air gaps between substrates.
- More sections per bandwidth for better coupling flatness.
- Electrically shorter and physically smaller RF components.

### Features:

High Power      Wide Bandwidths      Small Size      Excellent Amplitude Balance

### Electrical Specifications:

Frequency: 20 - 1000 MHz  
Power: 150 W CW  
Insertion Loss: 0.8 dB Max.  
VSWR: 1.40:1 Max.  
Phase Balance:  $\pm 12^\circ$  dB Max.  
Amplitude Balance:  $\pm 0.25$  dB Max.  
Isolation: 20 dB Min.

### Mechanical Specifications:

Material: Aluminum 6061-T6  
Surface Finish: Chem. Film Per MIL-DTL-5541F Type II Class 3 (Clear Iridite)  
Operating Temperature:  $-55^\circ\text{C}$  to  $+75^\circ\text{C}$   
Storage Temperature:  $-60^\circ\text{C}$  to  $+85^\circ\text{C}$   
Size: 3.0 x 2.75 x 1.0"

### Port Configurations:

Model	Sum Port (J1)	0°, -90° (J2, J3)
QH10738-T	Tab	Tab

**Werlatone's** breakthrough technology allows us to build our existing line of Broadband 3 dB High Power 90° Hybrid Couplers. Connectorized 3 dB 90° Hybrid Coupler models are available with a choice of connectors. Several of our existing High Power 3 dB 90° RF Couplers are three port designs, wherein the difference port is internally terminated with a high power termination. This eliminates the need for a customer supplied external load for each Hybrid Coupler.

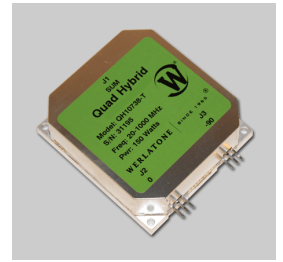

## PRODUCT DATA SHEET

QH10738

### Performance Data (Specifications subject to change without notice):

Coupling:

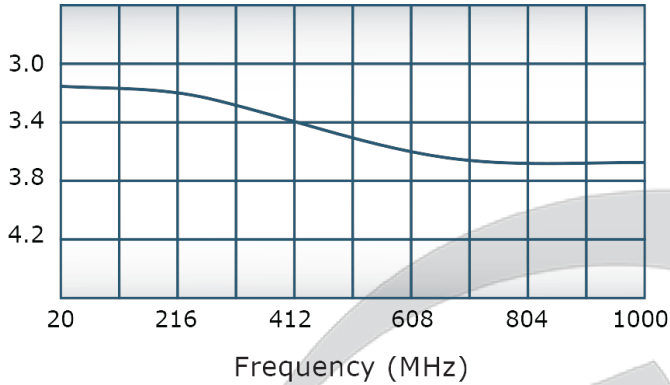

VSWR:

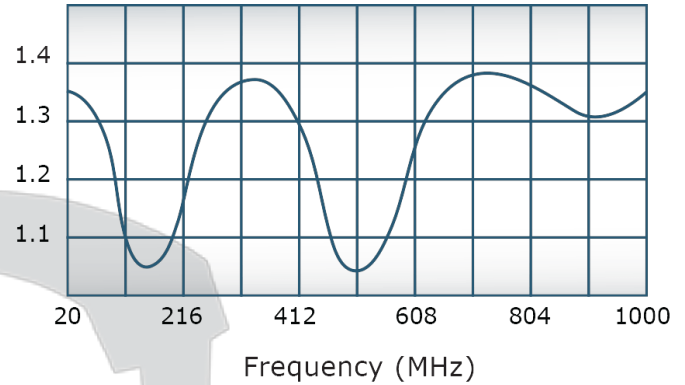

Isolation:

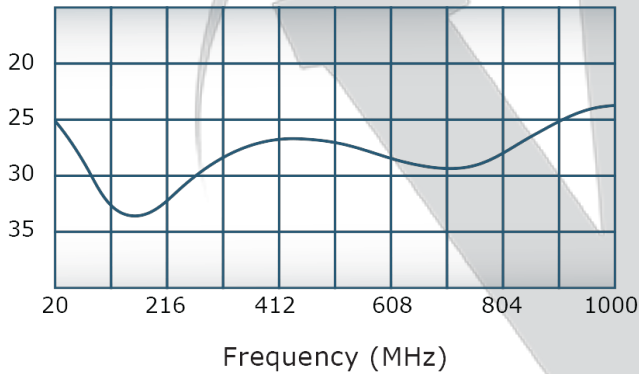

Phase Balance:

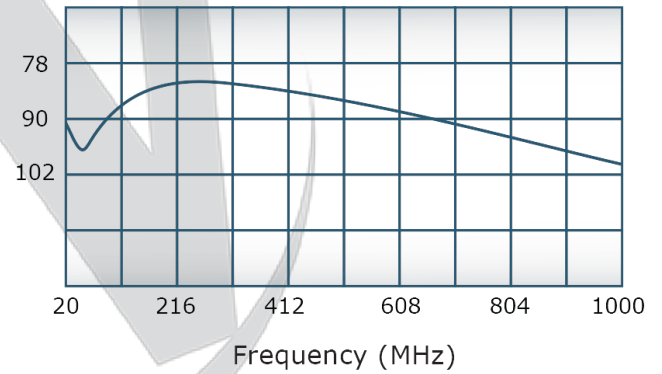

**Restriction on use, duplication, or disclosure of proprietary information.** This document contains proprietary information which is the sole property of Werlatone, Inc.

Werlatone, Inc. 17 Jon Barrett Road Patterson, NY 12563 T:(845)278-2220 F:(845)278-3440 sales@werlatone.com www.werlatone.com

THIS DRAWING CONTAINS INFORMATION  
PROPRIETARY TO WERLATONE INC. AND  
MAY NOT BE USED OR COPIED WITHOUT  
THE WRITTEN CONSENT OF WERLATONE INC.

DATE	SYM	REVISION RECORD	AUTH	DR	CK

TO BOTTOM OF TAB

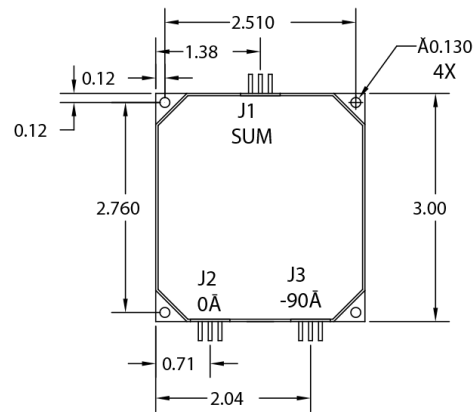
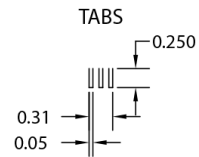
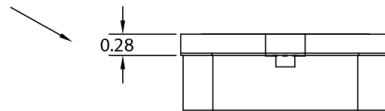

TO BOTTOM OF TAB

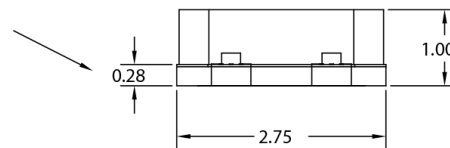

TOLERANCE	WERLATONE INC.			
XX +/- .015 XXX +/- .005	USED ON:	SCALE 1:1	DRAWN BY: PR APPVD BY: CS	
	TITLE <b>OUTLINE</b>			
	DATE 5/26/16	DRAWING NUMBER <b>21388-501</b>		

**Restriction on use, duplication, or disclosure of proprietary information.** This document contains proprietary information which is the sole property of Werlatone, Inc.  
Werlatone, Inc. 17 Jon Barrett Road Patterson, NY 12563 T:(845)278-2220 F:(845)278-3440 sales@werlatone.com www.werlatone.com